

MINI RAVIA FLUTED WALL HUNG

Features:

Code:MRV450WMWF

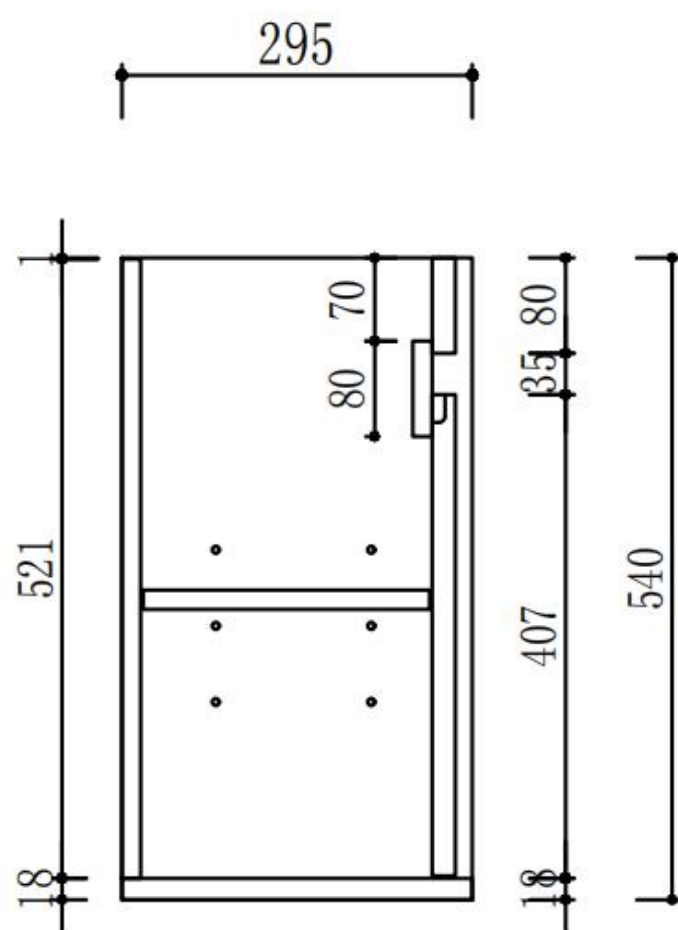
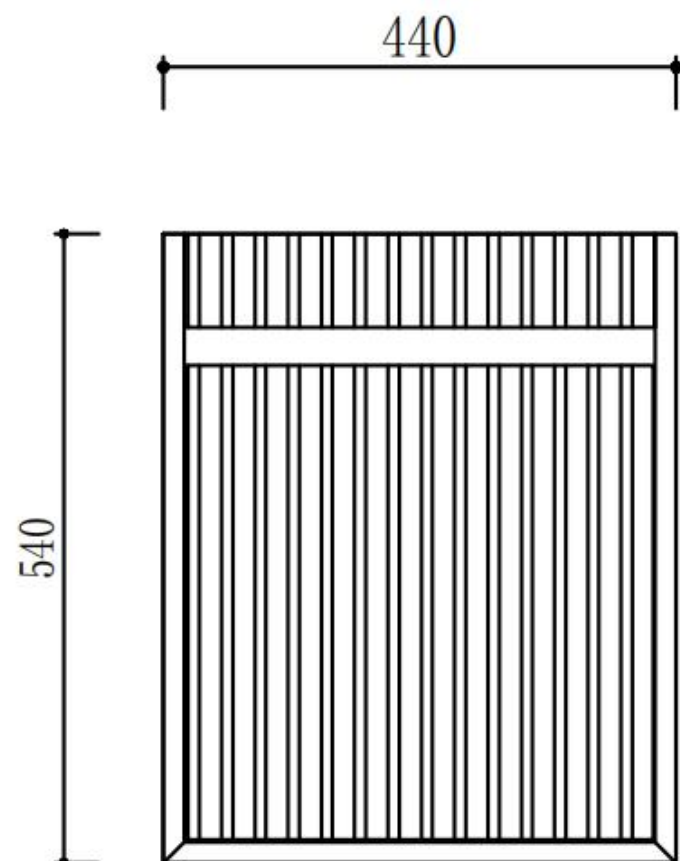

- Mini wall hung Vanity models Bevel edge design
- Premium grade durable timber plywood: Versatile and spacious.
- Contemporary peaked Ripple polyurethane Matte white finish
- Minimalist L-rail design finger pull drawers
- Premium graphite interior

