

## VOULARI FRAMED WALL HUNG **Features:**

Code:VO600WHA

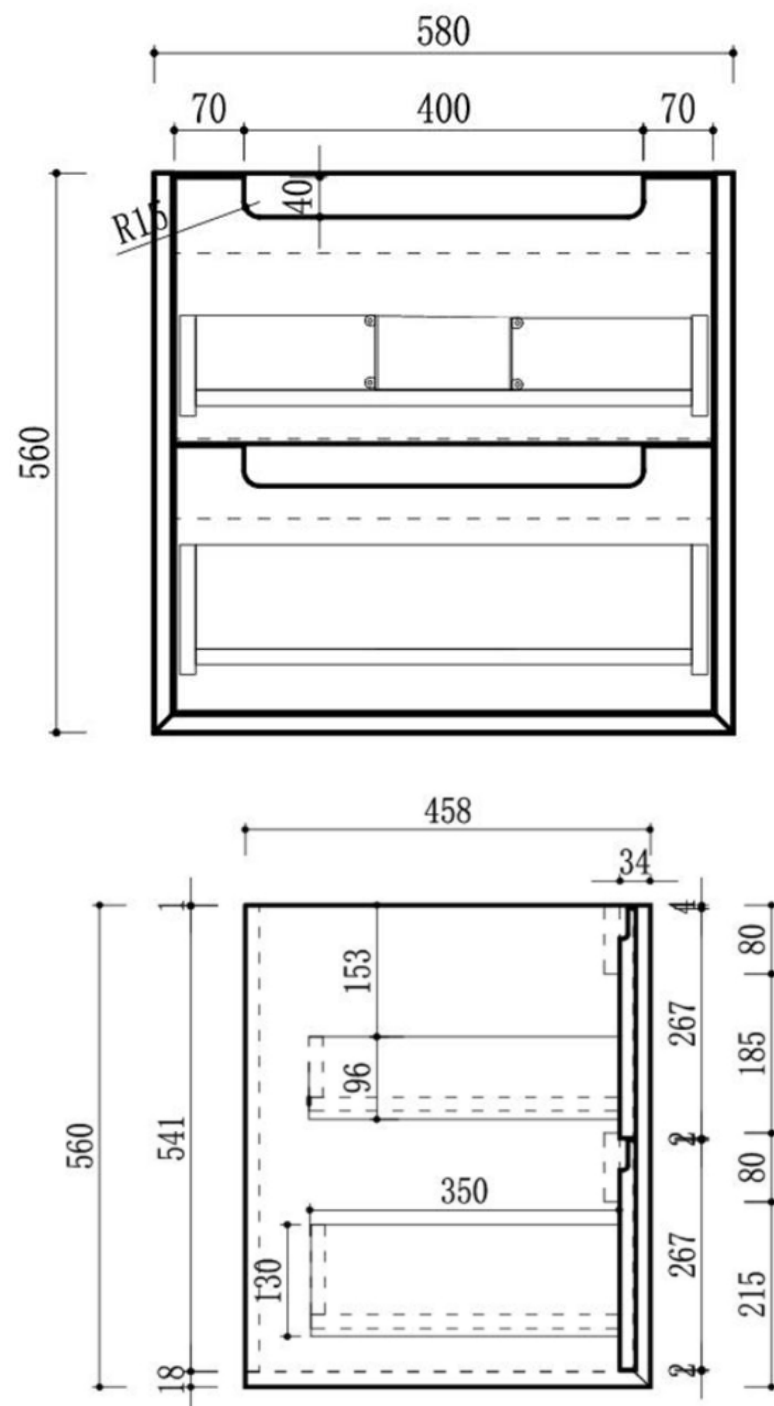

- All-drawers model Premium-grade
- Durable timber plywood
- Contemporary minimal groove natural timber grains with hard wearing laminate Harvest Oak finish
- Hettich Quadro S full extension soft close drawer runners
- Bevel edge design
- Drawer Organisers included
- Premium graphite interior.

