



# LUNA

## Above Counter Ceramic Basin

Model: ZUM6504

Above Counter Basin

Size: 580x360x100mm

Vitreous China

### Specifications & Data

#### TOP VIEW

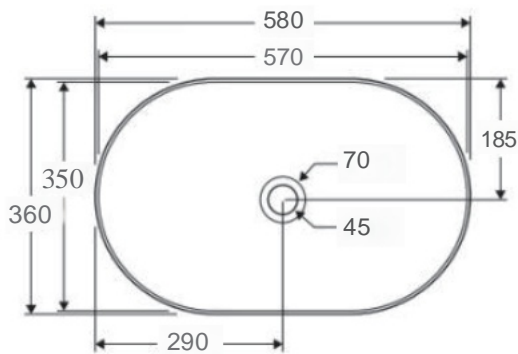

#### SIDE VIEW

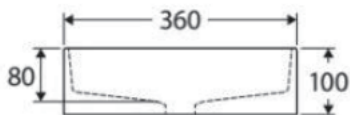

Tap Hole: N/A

Waste Outlet: 32mm Waste with 40mm Adapter

Bowl Capacity: 6.5L

Finish Colors: Gloss White

Over Flow: N/A

Fixing : Ceramic Pop Up Waste

Dimension: All dimensions are in millimetres and are subject to normal manufacturing variations.



ZUM6504

# INSTALLATION INSTRUCTIONS



*Great Services, Great Design, Great Product*

## Above Counter Basin



### Prior to Installation:

- Inspect basins to ensure no damages have occurred while in shipping.
- Observe all plumbing and building codes in accordance with your state and local requirements.
- Additional floor and wall preparations may be necessary to avoid damage to the product.
- We recommend professional countertop installers. Customer is responsible for damage to countertop and/or sink during installation.
- All dimensions are nominal! Be sure to measure your sink prior to installation.

**General Recommendations:** Read installation and maintenance instructions thoroughly before installing the basin. Be sure to use proper tools and always wear proper personal safety accessories for your protection.

### SUGGESTED TOOLS AND MATERIALS

· Drill

· Acetone

· Safety Glasses

· Pencil

· Tape Measure

## 1. Mark Faucet & Drain Location

- Place your basins in desired location on countertop and mark the drain and faucet hole with a pencil.
- Make sure clearance is suitable for backsplash, faucet, and plumbing for the sink.

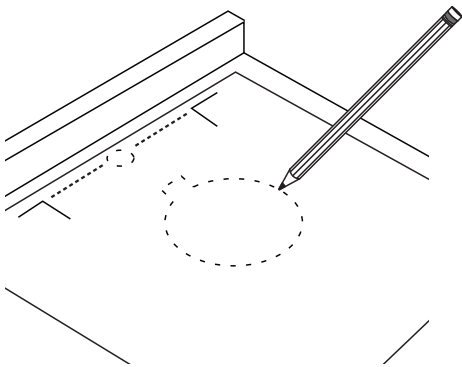

## 2. Drill Countertop

- Cut the opening for the drain in the countertop.

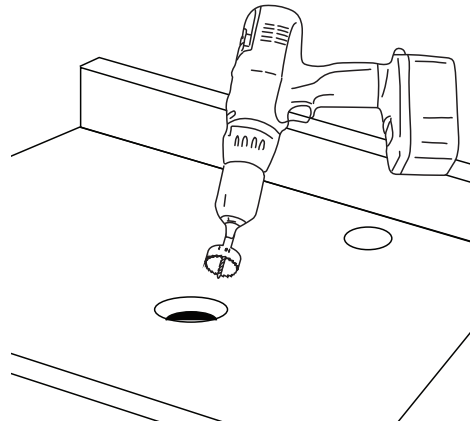

## 3. Install Faucet

- Install faucet (not included) according to manufacturer's instructions..

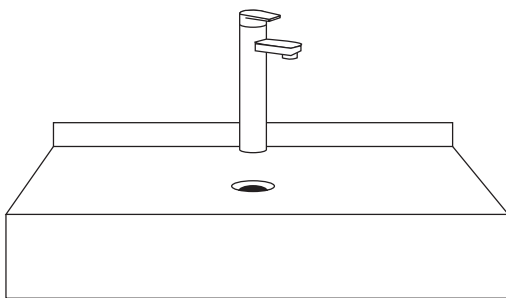

## 4. Install Basins

- Check alignment of the basin to the opening in the countertop.
- Use a bead of clear silicone (or preferred adhesive) around the underside of the sink.
- Carefully place the sink on the countertop, align, and press firmly.
- Allow sealant to set above 60 minutes.
- Use acetone or denatured alcohol to remove any excess sealant after application.

