

BACINO

Counter Top Ceramic Basin



Specifications & Data

SIDE VIEW

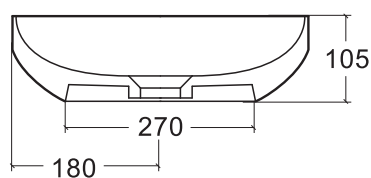

TOP VIEW

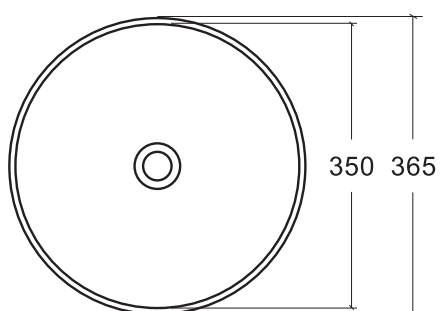

Model: Z3737MB

Above Counter Basin
Size: 365x365x105mm



Tap Hole: N/A

Waste Outlet: 32mm Ceramic Matching Color Pop Up waste with 40mm Adapter

Bowl Capacity: 6.5L

Finish Colors: Matte Black/Gloss White/Matte White/Matte Grey

Over Flow: N/A

Fixing: Ceramic Pop Up Waste

Dimension: All dimensions are in millimeters and are subject to normal manufacturing variations.



Z3737MG

Z3737GW

Z3737MW

INSTALLATION INSTRUCTIONS



Great Services, Great Design, Great Product

Above Counter Basin



Prior to Installation:

- Inspect The Ceramic Basin to ensure no damages have occurred while in shipping.
- Observe all plumbing and building codes in accordance with your state and local requirements.
- Additional floor and wall preparations may be necessary to avoid damage to the product.
- We recommend professional countertop installers. Customer is responsible for damage to countertop and/or basins during installation.
- All dimensions are nominal! Be sure to measure your Basin prior to installation.

General Recommendations: Read installation and maintenance instructions thoroughly before installing the basin. Be sure to use proper tools and always wear proper personal safety accessories for your protection. s

SUGGESTED TOOLS AND MATERIALS

·Drill

·Acetone

· Safety Glasses

·Pencil

·Tape Measure

1. Mark Faucet & Drain Location

- Place your sink in desired location on countertop and mark the drain and faucet hole with a pencil.
- Make sure clearance is suitable for backsplash, faucet, and plumbing for the sink.

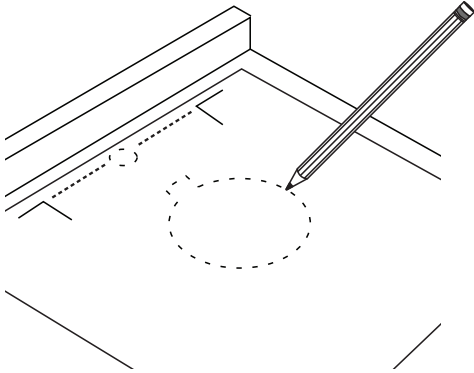

2. Drill Countertop

- Cut the opening for the drain in the countertop.

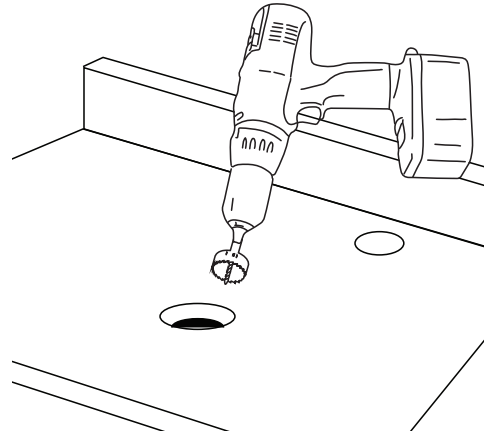

3. Install Faucet

- Install faucet (not included) according to manufacturer's instructions..

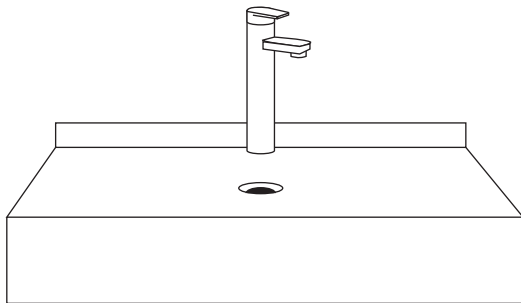

4. Install Basin

- Check alignment of the Basin to the opening in the countertop.
- Use a bead of clear silicone (or preferred adhesive) around the underside of the sink.
- Carefully place the sink on the countertop, align, and press firmly.
- Allow sealant to set above 60 minutes.
- Use acetone or denatured alcohol to remove any excess sealant after application.

