

INSTALLATION INSTRUCTIONS **DIVERTER MIXER WITH DIVERTER** **USING FOR:**

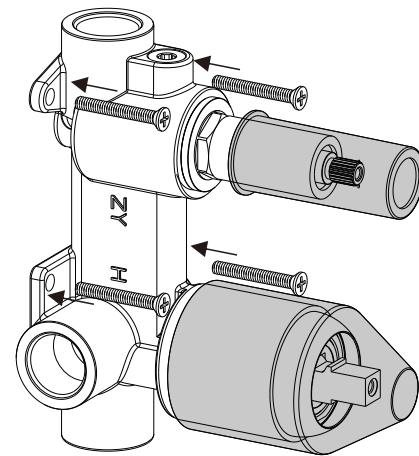

1. Mount the Mixer Body in Place Using the screws
2. Ensure the Mixer Body is level
3. Connect water supply and water outlet, test and check for leaks

1

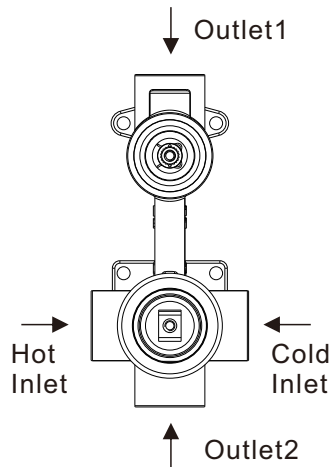
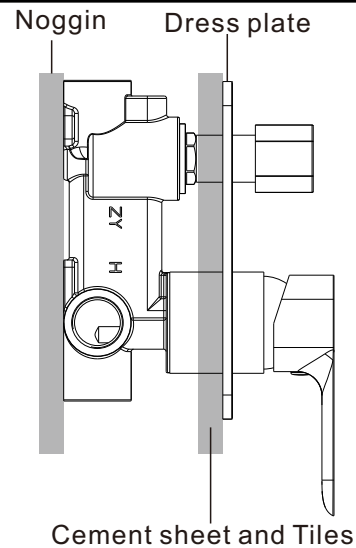
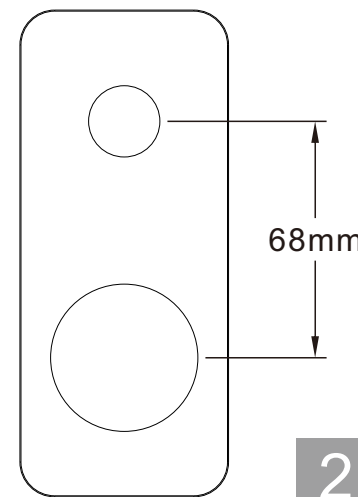

2

1. Create two suitable holes in cement sheet and tiles
2. Remove the protective cover, push the Dress Plate onto the body
3. Push on the handle and Diverter Cup then Fasten the Grub Screw
4. Fit Cap into position

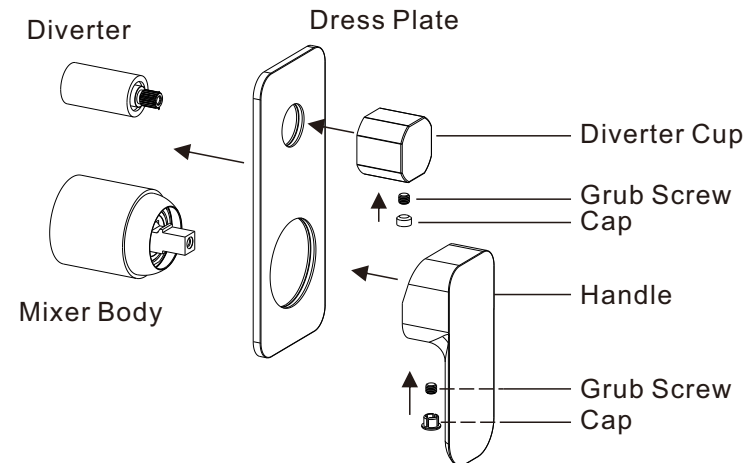

3



Recommended
 Working Pressure
 150-500kpa
 Maximum Hot
 Water Temperature
 75 degrees

Note:

1. If the pressure exceeds or likely to exceeds 550kpa, an approved pressure limiting device must be installed.
2. Flush Out all pipe work prior to installation.
3. If the water temperature exceeds 75°C, an approved tempering valve must be fitted.
4. Installation should comply with Australian Standard AS3500. Failure to comply with the above may void all warranties.

MAINTENANCE AND CARE:

1. Products Should be cleaned with mild liquid detergent or soap and water
2. Do not use cream cleaners or citrus based cleaning products, as they are abrasive.
3. Use of unsuitable cleaning agents may damage the surface. any damage caused in this way will not be covered by warranty

Disclaimer

While we aim to ensure the specifications shown are correct at the time of printing, Attica Australia reserves the right to make modifications without prior notice.