

Model: Z-28SM

Installation Manual

- Thank you for choosing our products. Please read the instructions carefully before installation and keep it available for future maintenance or reference.
- The ceramics in this manual are for reference only, and the actual ceramics shall prevail.

Content

Installation	Safety instructions	01
	Technical specification	03
	Parts identification	04
	List of materials	05
	Technical drawings	06
	Installation tools	07
	Pre-installation confirmation	08
Instructions for Use	Before installation	09
	Installation of intelligent cover plate	10
	Seat disassembly and installation	11
	Preparation	12
	Remote control illustration	13
	Description of The Knob Function	19
Maintenance	Maintenance	20
	1. Main unit care and maintenance	
	2. Spray nozzle care and maintenance	
	Emergency troubleshooting	21
	1. Power and water failure	
	2. Failure of remote control	
Others	Troubleshooting guide	22
	Warranty card	23

SAFETY INSTRUCTIONS

When using electrical products, especially when children are present, basic safety precautions should always be followed, including the following:

1. The appliance is not to be used by persons (including children) with reduced physical, sensory or mental capabilities, or lack of experience and knowledge, unless they have been given supervision or instruction.
2. This appliance can be used by children aged from 8 years and above and persons with reduced physical, sensory or mental capabilities or lack of experience and knowledge if they have been given supervision or instruction concerning use of the appliance in a safe way and understand the hazards involved.
3. Children should be supervised to ensure they do not play with the appliance.
4. Cleaning and user maintenance shall not be made by children without supervision.

READ ALL INSTRUCTIONS BEFORE USING

 **DANGER** – To reduce the risk of electrocution:

1. Do not place or store product where it can fall or be pulled into a tub or sink.
2. Do not place in or drop into water or other liquid.
3. Do not reach for a product that has fallen into water. Unplug immediately.
4. Do not wash the main unit or electrical plug with water or detergent.
5. Do not handle the electrical plug with wet hands.
6. Never block the outlet of the air dryer.
7. Never disassemble, repair or modify this product.
8. During installation, disassembly, repair and maintenance of the product, the power plug must be switched off and water supply be shut off.

 **WARNING** – To reduce the risk of burns, electrocution, fire, or injury to persons.

1. Close supervision is necessary when this product is used by, on, or near children or individuals with disabilities.
2. Use this product only for its intended use as described in this manual. Do not use attachments not recommended by the manufacturer.
3. Never operate this product if it has a damaged cord or plug, if it is not working properly, if it has been dropped or damaged, or dropped into water. Return the product to a service center for examination and repair.
4. Keep the cord away from heated surfaces.
5. Never use while sleeping or drowsy.
6. Never drop or insert any object into any opening or water supply pipe.
7. Do not use outdoors or operate where aerosol (spray) products are being used or where oxygen is being administered.
8. Connect this product to a properly grounded outlet only. See Grounding Instructions.
9. Do not throw cigarettes and other burning materials into toilet, otherwise it might cause fire.
10. This product is an electric appliance, so it must be placed far away from water and other liquid.
11. Do not lay the product on its side or upside down during the electrical circuit.
12. It is prohibited to use other electric appliances in the same socket.
13. It is forbidden to use the power extension or unstable loose outlet.
14. Do not reuse any existing water supply pipe, otherwise it might cause leakage, fire or electrical shock. Installation should include specified components and a new water supply pipe. Appliance is not to be connected by a hose-set.

SAFETY INSTRUCTIONS

 **CAUTION** – Failure to follow the instructions may cause bodily injury or property damage.

1. Do not install or use the product in wet places such as a steam room etc.
2. It is recommended to use water-proof electrical outlet which should be installed in a place where is not easily to get wet.
3. This product should be used with 220V-240V, 50/60Hz electrical current only, load current is at least 10A. Power plug must be equipped with ground fault circuit interrupter or ground fault electrical leakage protector or similar high sensitive, rapid type leakage switch. (Rated sensitive current under 10mA).
4. When it thunders, it is strongly recommended to pull out the power plug.
5. Do not stand on product unit, seat and lid.
6. Do not lean against the lid when using the product, to avoid damage.
7. This product is equipped with a soft-closing seat and lid. Do not push the toilet seat closed, or damage may occur.
8. Do not use any caustic chemicals or scrubbing brush to clean this product.
9. Exposure to direct sunlight is prohibited.
10. Only use tap water or potable water; otherwise it may cause chafing.
11. Do not connect water supply to a hot water supply. Make sure inlet water temperature is between 3~35°C/37.4~95°F.
12. Raise room temperature to prevent the toilet from damage due to freezing.
13. When not using the product over three(3) days, drain the water out of the toilet and pull the electrical plug from the wall outlet.
14. Stop using the product and shut off the power when product malfunctions. Call for professional service.
15. If this product is installed without a power plug, a power circuit breaker should be connected in series in the power input loop of the same room where the product is installed to ensure safe use.
16. If this product is installed without a power plug, a switch device capable of disconnecting the power supply of this product must be installed in the front end of the fixed wiring.

GROUNDING INSTRUCTIONS

This product should be grounded. In the event of an electrical short circuit, grounding reduces the risk of electric shock by providing an escape wire for the electrical current.

The plug must be plugged into an outlet that is properly installed and grounded.

 **DANGER** – Improper use of the grounding plug can result in a risk of electric shock.

If repair or replacement of the cord or plug is necessary, do not connect the grounding wire to either flat-head terminal.

Check with a qualified electrician or serviceman if the grounding wire instructions are not completely understood, or if in doubt as to whether the product is properly grounded.

This product is factory equipped with a specific electric cord and plug to permit connection to a proper electric circuit. Make sure that the product is connected to an outlet having the same configuration as the plug. No adapter should be used with this product. Do not modify the plug provided — if it will not fit the outlet, please have the proper outlet installed by a qualified electrician. If the product must be reconnected for use on a different type of electric circuit, the reconnection should be made by qualified service personnel.

SAVE THESE INSTRUCTIONS

Technical specification

Main Unit	Rated voltage	220V-240V, 50Hz-60Hz
	Rated power	1010W
	Water proof	IPX4
	Water pressure range	0.08MPa - 0.8MPa (static pressure)
Cleaning device	Heating power	1600W
	Water temperature	6-level adjustment (Neutral level included)
	Water volume	3-level adjustment
	Cleaning mode	Rear washing /Oscillating washing, Front washing /Oscillating washing
	Nozzle position	5-level adjustment
	Water pressure protector	Pressure maintaining device, Automatic pressure relief device
	Anti-fouling device	Automatic nozzle cleaning, Anti-syphon device, Anti-backflow device, Filter device
	Safety device	Thermal fuse, Water temperature sensor, Over temperature Ground protection, Thermostat, protection, Leakage protection device
Drying device	Warm air speed	0.2m³/min
	Warm air temperature	6-level adjustment (Neutral level included)
	Heating power	200W
	Safety device	Thermal fuse, Leakage protection device, Thermostat
Caring device	Night light assembly	Intelligent, Always on, Always off
	Noise-free setting	The buzzer is off at night for a quiet environment.
	User ID setting	To avoid interference when used by multiple users
Antibacterial site		Nozzle

Rated power: Under the condition of ambient temperature 23°C/73°F, water static pressure 0.18MPa±0.02MPa, water temperature 15°C/59°F, power toilet on, set water pressure, seat temperature, water temperature to the highest level in turn and perform one rear washing cycle.

Technical specification

Left side

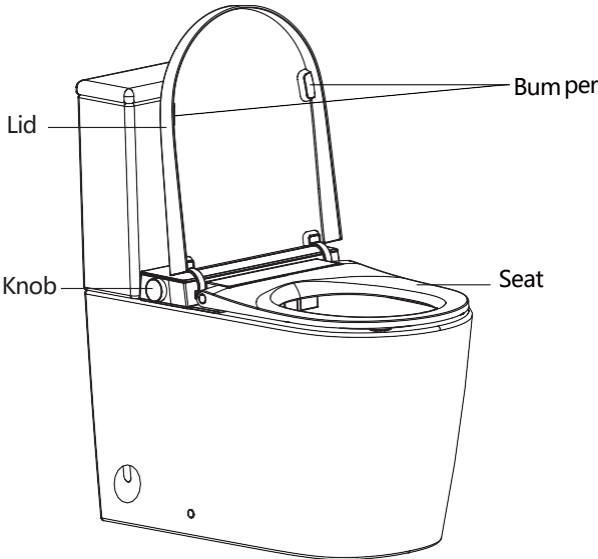

Right side

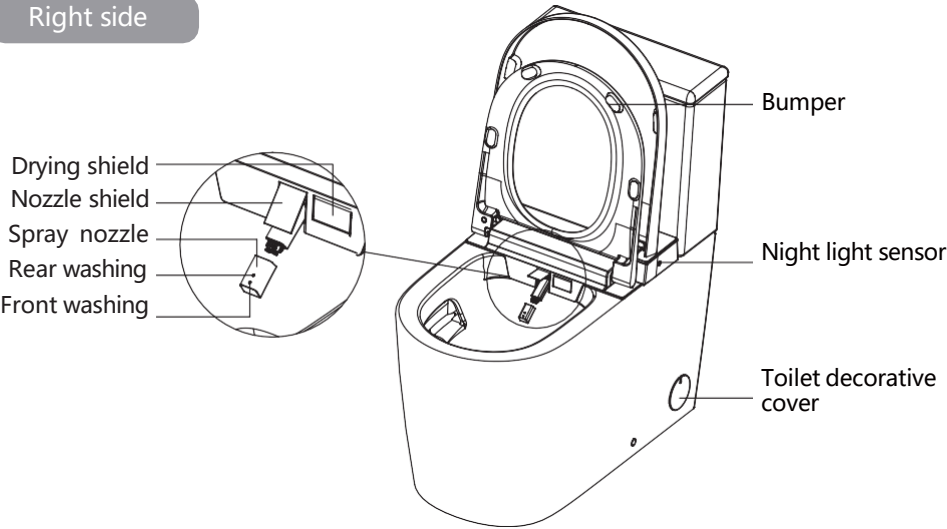

List of materials

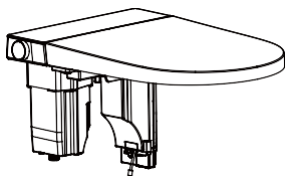

Main Unit



Remote Control Components



Installation Manual



Three-way valve



Decorative Cap



Water supply pipe



Toilet decorative cover



Double check valve

List of materials

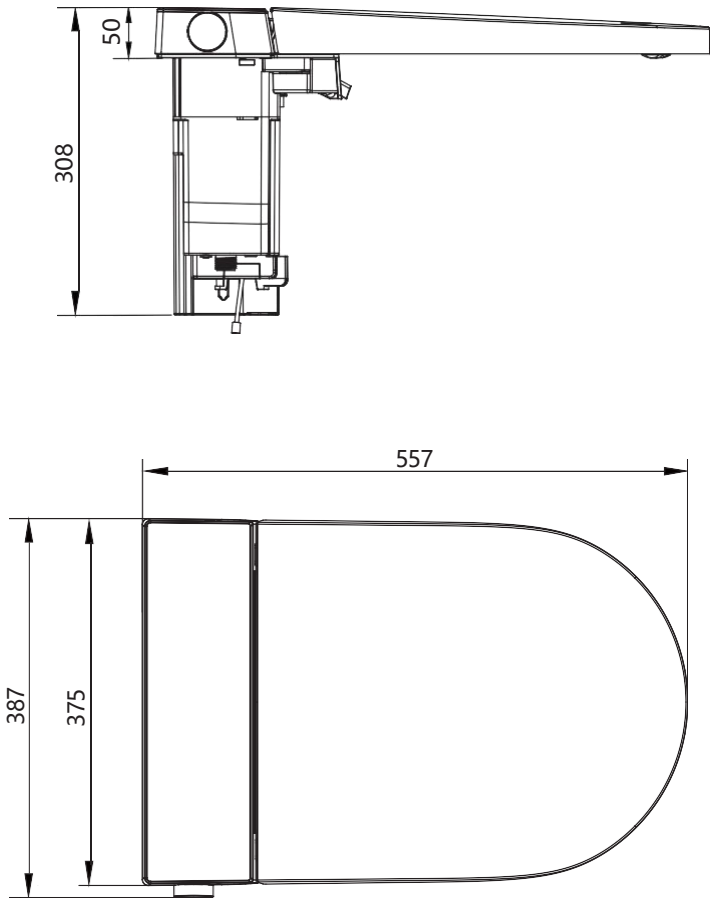

Installation tools



Drill
(with 1/4" drill bit)



Caulk gun



Saw



Marker



Tape measure



Assorted spanners



Wire stripper



File

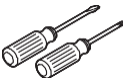

Assorted screwdrivers

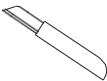

Cutter



Teflon tape

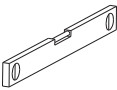

Spirit level



Ruler

Installation tools

Circuit pre-installation: Install a fixed electrical supply circuit (Neutral wire, live wire and ground wire included.)

- Confirm the electrical connection location.
- Reserve pipeline for electrical circuit

Circuit breaker pre-installation

- Connect a separate upstream circuit breaker.
- Pre-connect an earth leakage circuit breaker or grounding protector for other independent circuits.

Waterway pre-installation

- Reserve pipeline for water supply pipe.

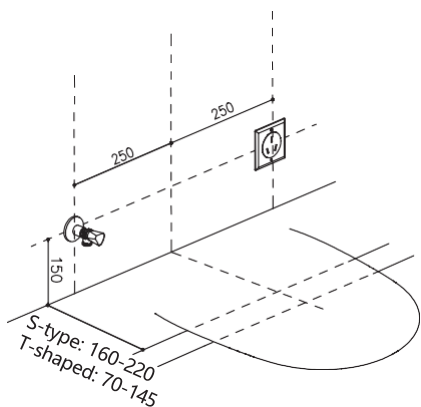

P-trap

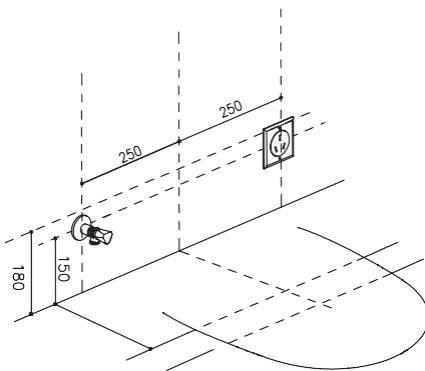

S-trap

After installation

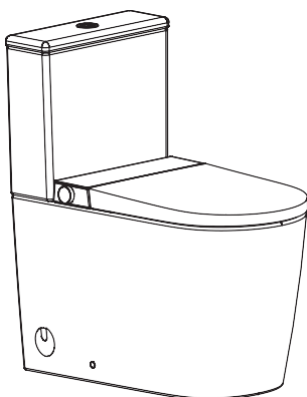

Before installation

WARNING: This product is required to be installed in accordance with the National Construction Code Volume Three -Plumbing Code of Australia.

This product includes an integral air gap high hazard backflow prevention device that complies with AS2845.2:2010. No further backflow prevention is required for this connection to water supply.

The seat is a special type that only fits certain pans (model: MB-028, WMK26867)

1. Minimum static water pressure: 0.08+MPa (8.5+L/min), failure to meet this pressure will not achieve the best flushing effect.

Note: Apply the methods below if you don't have water pressure testing device. Open the angle valve to check the water volume. If the water volume after 10 seconds is greater than 1.42L, then it is OK to proceed installation.

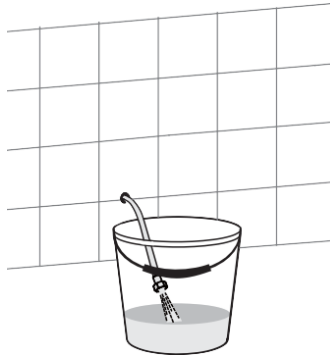

Before installation

1. Install the inlet water supply pipe

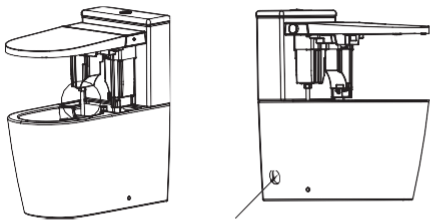

Note: Users can choose the power cord and water inlet braided pipe to be threaded out from the left/right hole according to their preferences and bathroom water and electricity layout. If the water inlet pipe is not long enough, users need to purchase an external connection by themselves.

2. Install the cover into the ceramic toilet bowl

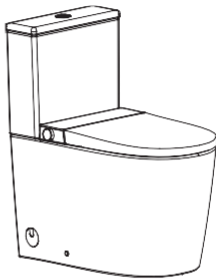

Place the electronic cover in the toilet, adjust alignment, and ensure even gaps.

3. Lock the cover plate

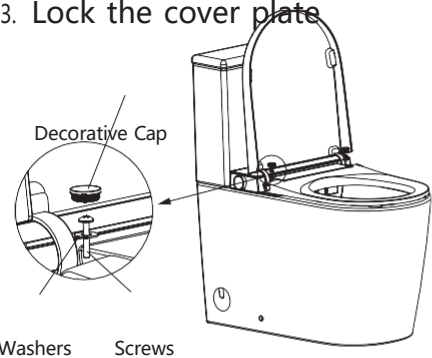

Open the toilet cover, lock in the screws and washers, cover the decorative cap, cover the seat ring and toilet cover.

5. Installation completion rendering

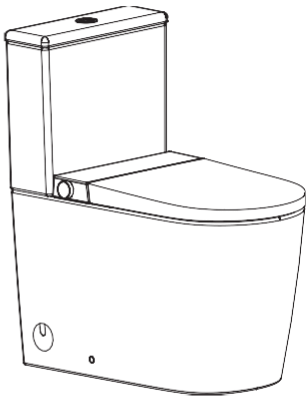

Seat disassembly and installation

Seat disassembly

1. Open seat at 90°.
2. Press down button on the left side, button pops out and seat unlocks.

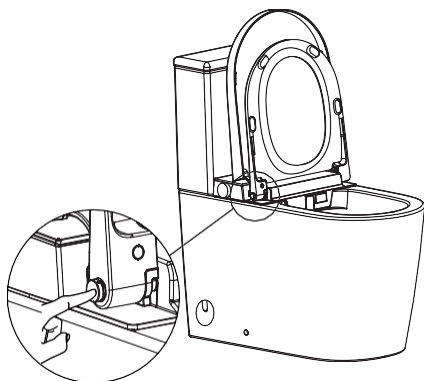

3. Tilt seat to the right hinge, pull seat out from the left hinge socket first and then the right.
4. Remove seat.

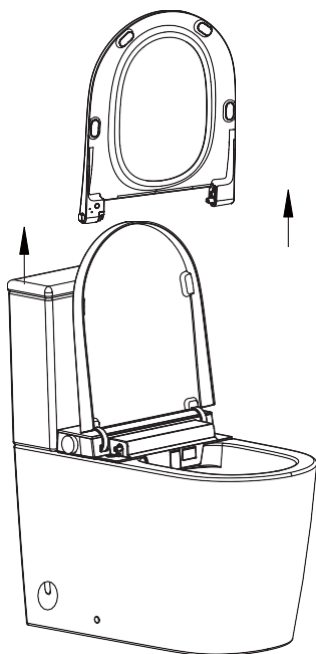

Seat installation

1. Fit seat at 90°.
2. Insert the right hinge first and then the left.

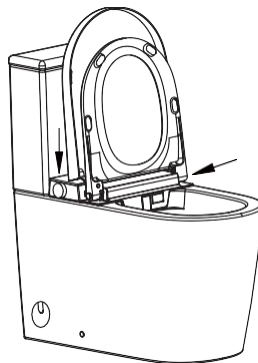

3. Press down button on the left side and seat locks.

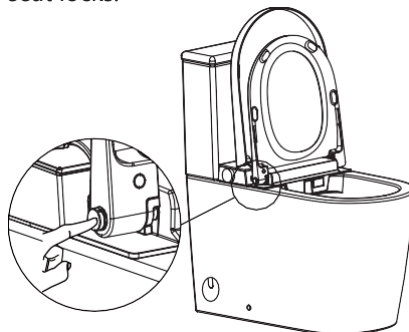

4. Put seat horizontally.

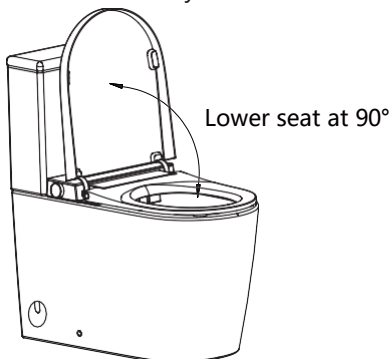

Seat disassembly and installation

Before use, press the reset switch and the button light will light up, indicating power on.

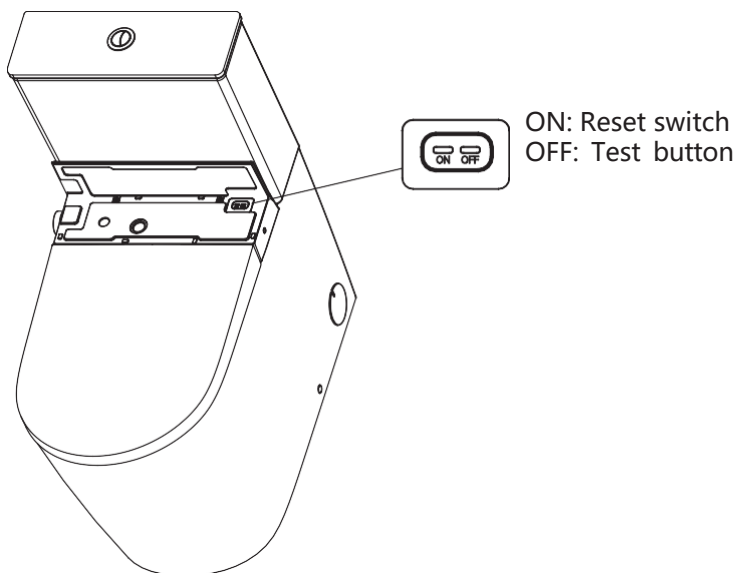

Warm reminder: Press the test button before use. The reset switch pops up, indicating that the leakage protection function is normal.

Remote control illustration

Remote control holder installation 1 :

1. Drill a 6 mm diameter hole in the wall to a depth of about 35 mm.
2. Remove the double-sided adhesive tape on the back of the holder.
3. Install an anchor into the hole, stick the holder to the wall and secure with screws and then stick the patch with tape.

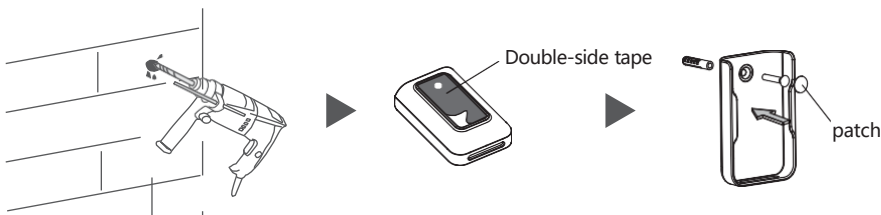

Remote control holder installation 2 :

1. Clean and dry the pre-installation area of the holder.
2. Remove the double-sided adhesive tape on the back of the holder.
3. Stick the holder to the wall vertically and then stick the patch with tape.

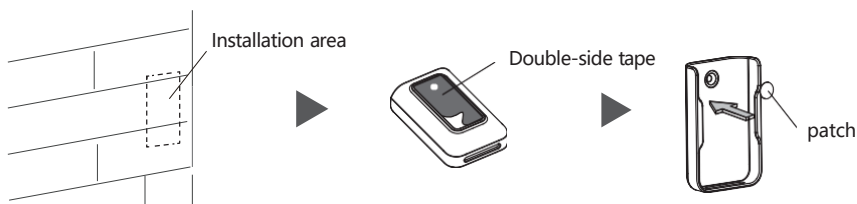

Battery installation:

1. Insert batteries into the remote control.
2. Put the remote control to the holder.

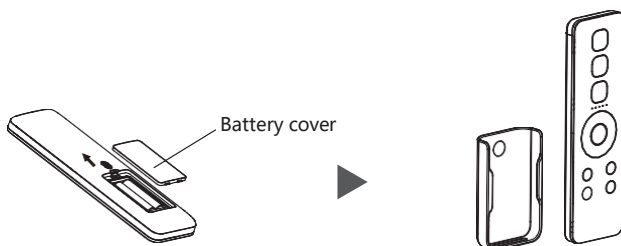

Notice:

1. Please ensure the remote control is within reach when a person on the seat.
2. Do not install and use the product in damp places such as a shower room.
3. Do not place the product in a place where it is easily exposed to water.

Remote control illustration

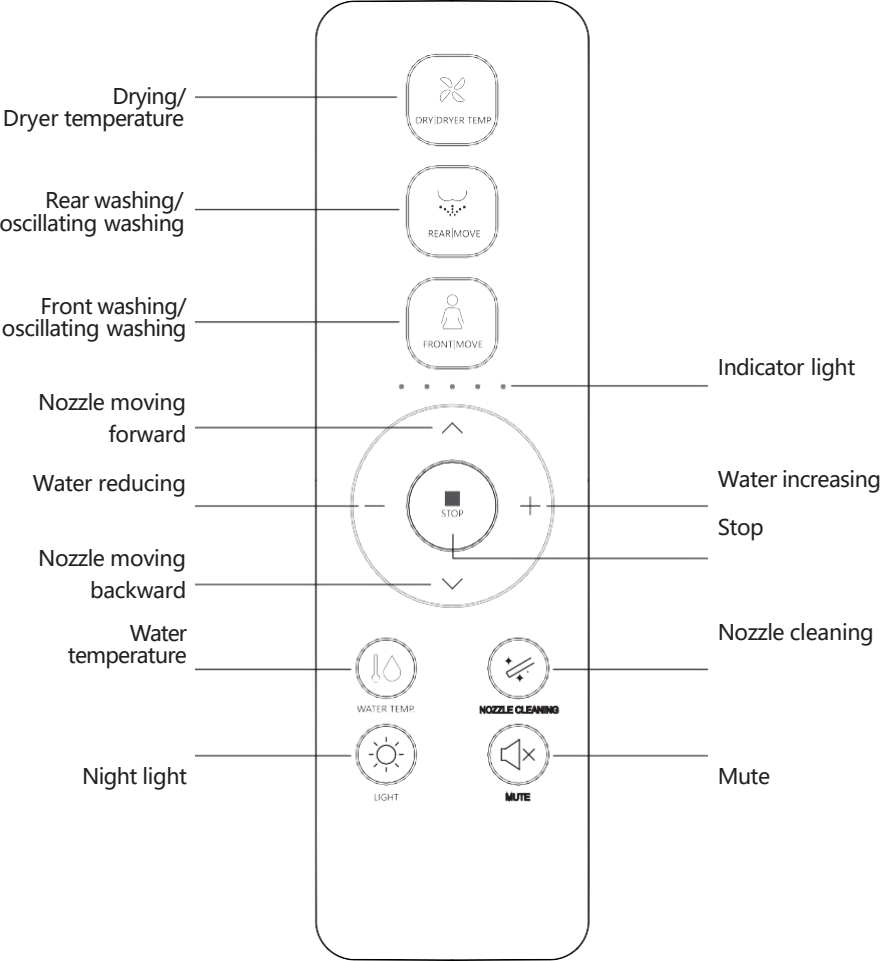

Remote control illustration

Notice :

- Only when the user is seated and the buzzer beeps can the functions of front/rear washing and drying be activated.
- The nozzle will continue to spray for 1-2 seconds after user stands up during washing, so please press "STOP" button before standing up.

REAR|MOVE



- Press " " button, the indicator light is on showing current water temperature level, it starts rear washing; Press again " " button to shift to oscillating washing (nozzle moves forward and backward to expand washing area). The washing will stop automatically after one cycle, while it will stop immediately if the user presses " " button.

FRONT|MOVE



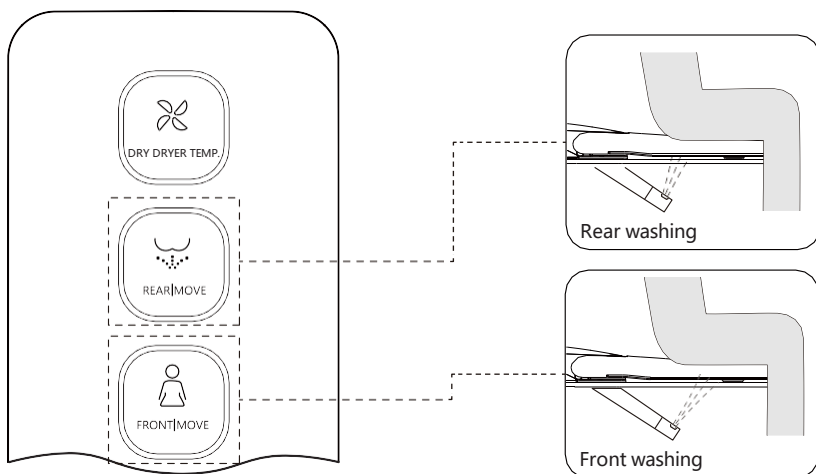

- Press " " button, the indicator light is on showing current water temperature level, it starts front washing; Press again " " button to shift to oscillating washing (nozzle moves forward and backward to expand washing area). The washing will stop automatically after one cycle, while it will stop immediately if the user presses " " button.



Remote control illustration

DRY|DRYER TEMP



- ① Press "  " button, the indicator is on, showing the current air temperature level. It will stop drying automatically after one cycle or after leaving.
- ② Under drying, press "  " button to adjust the air temperature between 0-5 level, and the indicator light is on showing the air temperature level. When the indicator light is off, the temperature is at level 0 (room temperature).

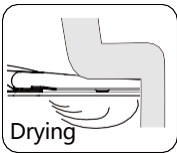

Water volume adjustment

- Press "+" or "-" button when it is under function of rear washing or front washing, the indicator light is on showing current water volume level, and water volume can be adjusted.

Nozzle position adjustment

- Press "▲" or "▼" button when it is under function of rear washing or front washing, the indicator light is on showing current nozzle position, and nozzle position can be adjusted in 5 levels.

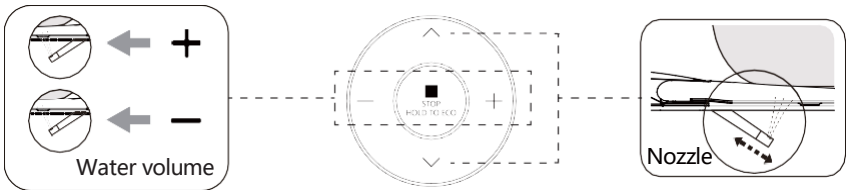

Water temperature adjustment





- Short press "  " button to adjust the water temperature between 0-5 level. The indicator light is on showing current water temperature level. When the indicator is off, the temperature is at level 0 (room temperature).



Remote control illustration



Nozzle cleaning



When no one is seated, short press "  " button, the nozzle will automatically stretch out to allow access for cleaning. Press "  " button to return the spray wand to its normal position.

Night light



- Night light adjustment: Short press "  " button to turn on/turn off night light.
- Intelligent mode: Long press "  " button to enter into intelligent mode (Night light will be on or off depending on the surrounding light.). If the product is on intelligent mode, short press "  " button to exit intelligent mode. (Factory setting: intelligent mode)



Quiet mode



Short press "  " button to turn on/off quiet mode.

User code

- Radio frequency remote control

- ① Shut off the power supply of toilet
- ② Press and hold "  " button, then press "  " button, the indicator light will flash.
- ③ Re-connect the power plug and press "Reset" button.
- ④ The indicator stops flashing and stays on for 2 seconds, indicating that the remote control and the toilet are matched successfully. It beeps once when the self-inspection completes. Then the remote control is ready for use.





Remote control illustration

Other operations

Sterilization function

- When no one seated and washing/drying is off, long press "  " button to turn on plasma sterilization function. This function will stop automatically after 2 hours. Under this mode, if any other button is pressed or user is seated, it will stop automatically.

Electronic bidet tank flushing

- Press and hold "  " and "  " button simultaneously for longer than 3 seconds to start the flushing by water tank of electronic bidet.

Remark:

- The buzzer will "BEEP" once when the user presses one button indicating that the main unit receives the signal and conduct the operation accordingly. If the buzzer doesn't sound, it means the main unit doesn't receive the signal, please adjust the remote control direction and repress the button.
- In case of power cut during nozzle spraying, the wand cannot be retracted, please wait until the power is restored. In case of a power cut for a long period, please push the wand softly back by hand. Do not push hard, to avoid damage to wand and electrical machine.

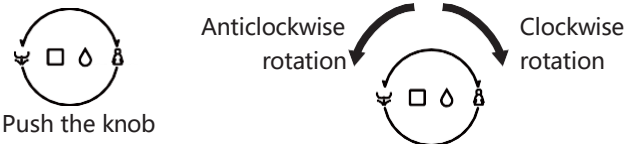

Description of The Knob Function

<div>Knob definition</div> <div>Knob function</div>	<div></div> <div>Push the knob</div>
Rear wash/ front wash	When seated, rotate the knob clockwise to activate the front washing function, and counterclockwise to activate the rear washing function. After cleaning, the drying function will automatically turn on. If the knob is pressed briefly during cleaning, the current function is stopped.
Nozzle position adjustment and cleaning water pressure adjustment	When rear/front washing, turn the knob clockwise to move the nozzle position forward, and turn the knob counterclockwise to move the nozzle position backward. Long press the knob to switch to water pressure adjustment, turn clockwise to increase the water pressure, counterclockwise to decrease the water pressure, long press the knob again to switch to nozzle position adjustment.
Drying/Dryer temperature adjustment	1. When seated and the function is not turned on, press and hold the knob to start the drying function. If the knob is pressed briefly during drying, the current function is stopped. 2. In the drying state, turn the knob clockwise to increase the air temperature, and counterclockwise to decrease the air temperature.
Nozzle cleaning	In the state of leaving the seat, turn the knob clockwise to start the nozzle manual cleaning function; short press the knob to stop the manual cleaning function, and the nozzle retracts.

Reminder: Upon startup, all function settings default to the middle setting. After using the remote control, the function setting will switch to what was set on the remote.

Description of The Knob Function

Main unit care and maintenance

1. Shut off power supply before doing maintenance.
2. Use only a soft, damp cloth to clean. Avoid using harsh chemicals.

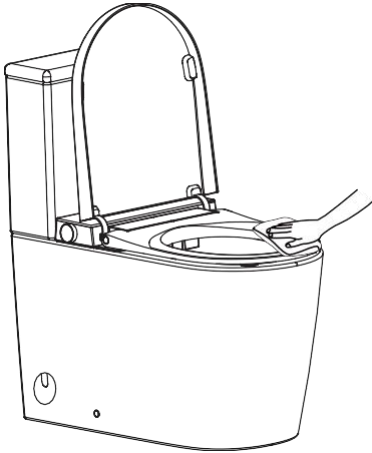

3. Once cleaning is completed and all surfaces are dry, re-connect the power plug.

Spray nozzle care and maintenance

1. When no one is seated, turn the knob clockwise. The nozzle will automatically stretch out to allow access for cleaning.
2. When the nozzle moves forward, the nozzle can be removed and cleaned separately.

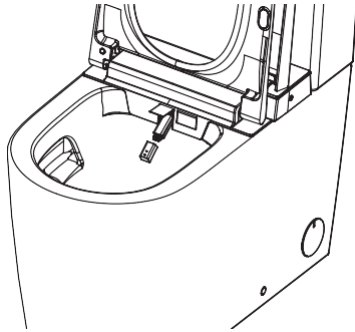

3. Use only a soft cloth or soft brush to clean. Do not pull or push the wand, to avoid damage.

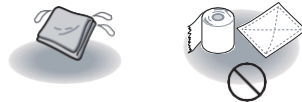

4. Put the nozzle back and press the knob to return the spray wand to its normal position.

Note:

The spray wand will retract automatically after 10 minutes or if the seat is used.

Emergency troubleshooting

Power and water failure

- Put around 8L water into a barrel and flush the ceramic bowl.

Note: Avoid water spilling from bowl.

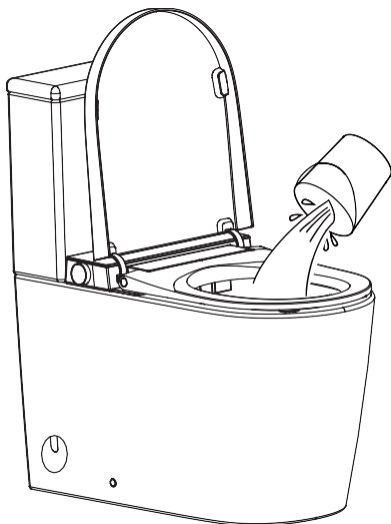

Failure of remote control

1. Operate via knob on the main unit.

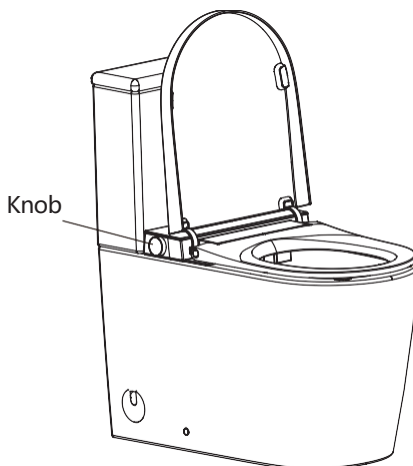

2. Battery replacement

- Remove the remote control from holder.
- Open the battery cover and replace the batteries.
- Put the remote control back.

Note:

After battery replacement, the settings of auto functions and energy saving will be restored to the defaults. Please reset.

Problem	Cause	Solution
No water from nozzle	Water supply pipe is kinked	Straighten the pipe to remove the kink
	Angle valve is off	Turn on the angle valve
	A water failure occurred	Restore the water supply
Poor water spraying	Water supply pipe is kinked	Straighten the pipe to remove the kink
	Angle valve is not fully turned on	Turn on the angle valve fully
Low water temperature	The water temperature is not set properly	Adjust the water temperature
Low dryer temperature	The dryer temperature is not set properly	Adjust the dryer temperature
Dryer not blowing	In standby mode or energy saving mode	Switch to functional mode to use dry function
Spray wand cannot retract	Power off	Push back the spray wand gently and put power on
	Get stuck by impurities	Remove the impurities
Spray wand cannot stretch out	Power off	Turn on the power
	User is not within the sensing area of the seat	Adjust position on seat to activate the sensor
Remote control cannot display	The positive and negative direction of the batteries is incorrect	Reload the batteries
	Low battery	Replace new batteries
 CAUTION	If the problem cannot be resolved as per above solutions, please disconnect the power and contact service providers.	
	If the power leakage protection switch always trips, it means that the product is leaking. Please disconnect the power and contact service providers.	



Product warranty card

Model No.		Customer Name	
Seller		Purchasing Date	
Invoice No.		Customer Contact	
Distributer Stamp		Distributer Phone	

Thank you for choosing our product. This product is warranted for five (5) years since the purchasing date for free repair of problems arising out of defects in workmanship while using in accordance with installation manual and usage cations for intended purposes.

If the product does nat work properly with warranty period, please contact your nearest service center. This certificate must be presented to obtain free service under this warranty.

Our company reserves the rights to replace the product by other similar models. We can serve to fix or repair the product at a reasonable service charge, after expiration of warranty period.

Service charges shall be paid even during the warranty period, if breakage or damage is caused by any of the following events (including but without limitation).

1. The user's negligence or mistake in operation, unreasonable repair or alteration.
2. Product are damaged by negligence or mistake during installation.
3. The movement of installation location of the product.
4. Using the product outside of intended use in residential housing or commerical hotels.
5. The use of non specified power supply (voltage, rating pressure)
6. The dirt, sand and impurities that causing invalid operation.
7. Damages due to force majeure (including but not limitation to natural disaster) or other incidents.
8. The user fails to use in compliance with the warning or caution described in the installation manual.

Remark:
Please fill in date, seller correctly. If there are some mistakes, the warranty will get invalid. This five year warranty for free of charge of repair service is only for the items listed in the warranty.
The purchasing date is subject to the purchasing invoice or receipt.
Please keep this warranty and invoice/receipt available for repair or maintenance.



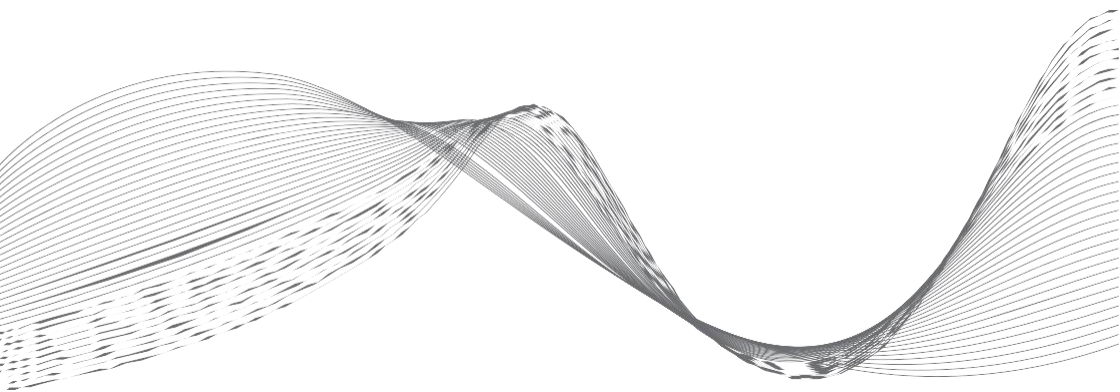

Tel: 61-0390187903

E-mail: warranty@zumibathware.com.au

www.Zumibathware.com.au

The picture of product may not be entirely consistent with actual appearance and color because of product improvements, please in kind prevail.